

Helvar

Quick Start Guide

In partnership with Aranet

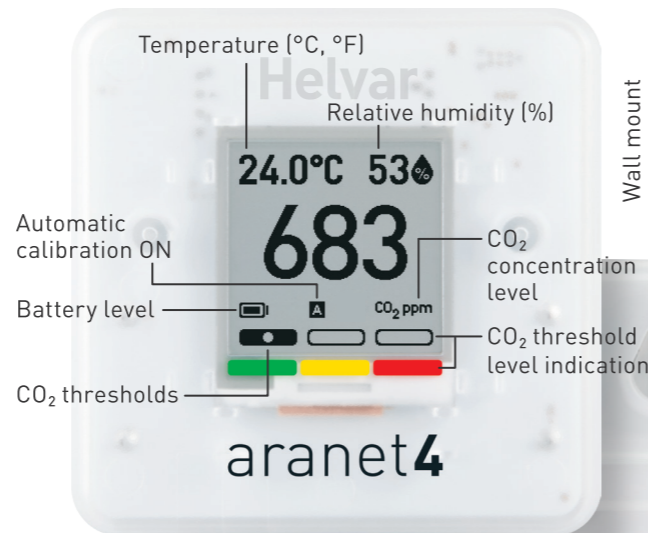

Configuration switches

Do not alter these switch positions unless instructed by Helvar

Change CO₂ calibration mode *

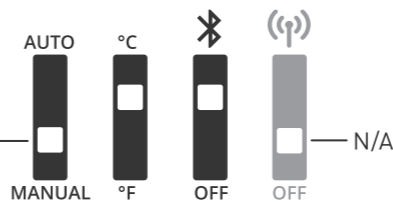

Change temperature units

Turn on or off Bluetooth

* Aranet4 has been calibrated at the factory, so no need to change the calibration mode now.

We're based in Finland, Sweden and the UK - but we work with Partners all over the world.

Finland HQ:
Helvar Oy AB
Keilaranta 5
FI-02150 Espoo

Sweden:
Helvar AB
Åsögatan 155
SE-11632 Stockholm

UK:
Helvar Ltd
Hawley Mill, Hawley Road,
Dartford, Kent, DA2 7SY

See what's new at helvar.com

1

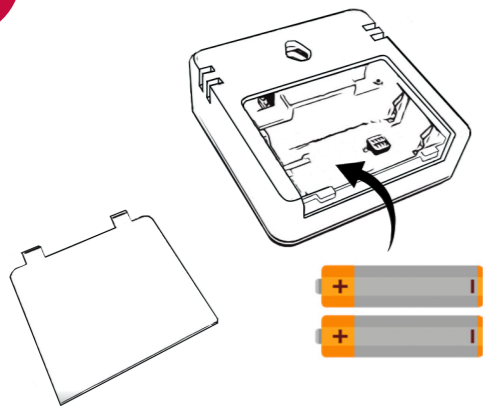

Insert batteries (included)

2



Aranet4 location installation recommendations:

- Freestanding on desk or wall mounted
- Keep Aranet4 sensor in Bluetooth distance of connected Helvar Environmental Sensor at all times

3



Download the Helvar app to connect Aranet4 sensor to the Helvar network.

(only to be carried out by Helvar trained engineers)

4



Place Aranet4 next to mobile device

In the Helvar App > Connect > Choose Helvar Environmental Sensor to pair Aranet4 with> Once connected> Devices Tab > + Add Sensors